

Forsyth County

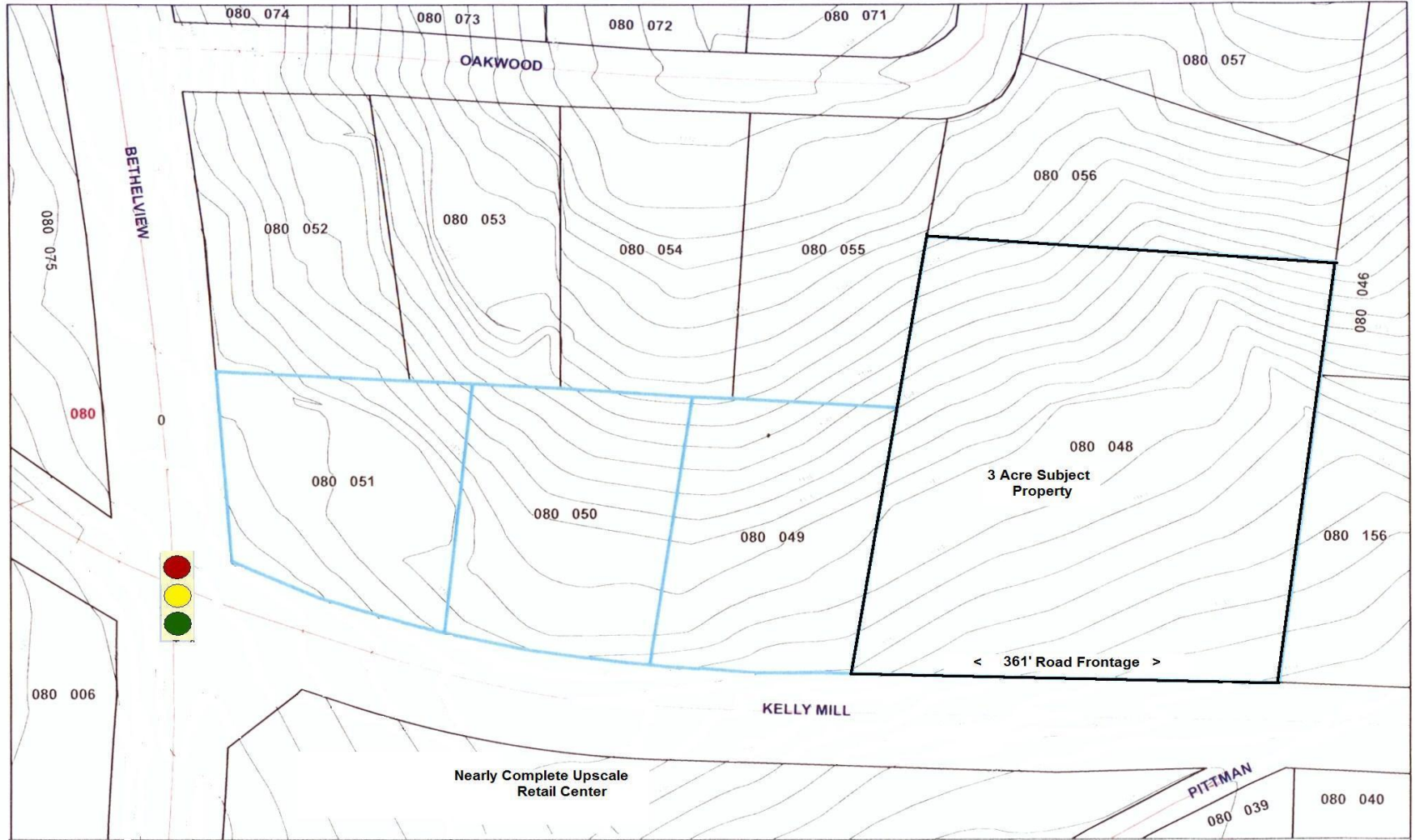

Legend

- STREETS
- TAX PARCELS
- STREAMS



Forsyth County GIS Department

1 inch equals 121.43 feet

Produced by the Department of GIS
Forsyth County, Georgia

Main Source: County's GIS Databases
Created in ArcGIS 9.2 using ArcMap

Coordinate System
State Plane: Georgia West FIPS 1002
Feet, U.S. Survey
Projection:
Transverse Mercator
Datum:
North American Datum of 1983

This is a public domain map. It is not a warranty, representation, or endorsement by the State of Georgia or Forsyth County. It is provided as a service to the public. The State of Georgia and Forsyth County are not responsible for any errors or omissions in this map. The user assumes all liability for any use of this map. The State of Georgia and Forsyth County are not responsible for any damages, including consequential damages, arising from the use of this map. The State of Georgia and Forsyth County are not responsible for any loss of data or information resulting from the use of this map. The State of Georgia and Forsyth County are not responsible for any other losses or damages resulting from the use of this map.

